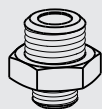

Accessories

4.3.3

page 28

**Reducing Nipple, male-male**

Cylindrical

Material: brass, nickel plated

Temperature range: -40°C ... +120°C

Maximum pressure: 50 bar

Conical versions on request.

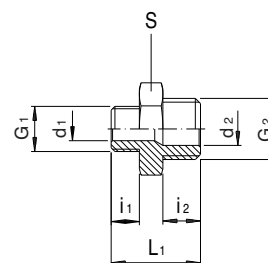

Port size G1	Port size G2	L1	i1	d1	i2	d2	S	Type
M 5	G 1/8"	14,5	4	2	6	5	14	251M-M5-1/8
G 1/8"	G 1/4"	19	6	5	8	7	17	251M-1/8-1/4
G 1/8"	G 3/8"	20	6	5	9	9,5	19	251M-1/8-3/8
G 1/8"	G 1/2"	21,5	6	5	10	13	24	251M-1/8-1/2
G 1/4"	G 3/8"	22	8	7	9	10	19	251M-1/4-3/8
G 1/4"	G 1/2"	23,5	8	7	10	13	24	251M-1/4-1/2
G 3/8"	G 1/2"	24,5	9	10	10	14	24	251M-3/8-1/2
G 1/2"	G 3/4"	27,5	10	14	12	18	30	251M-1/2-3/4

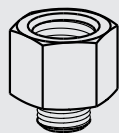
Dimensions might vary.**Reducer, female-male**

Cylindrical

Material: brass, nickel plated

Temperature range: -40°C ... +120°C

Maximum pressure: 50 bar

Conical versions and orientating versions on request.

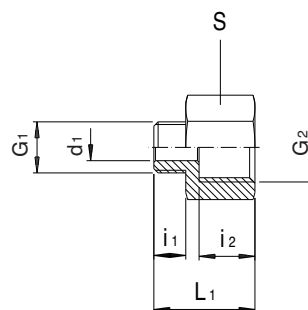

Port size G1	Port size G2	L1	i1	d1	i2	S	Type
M 5	M 5	11	4	2	5	8	252M-M5-M5
M 5	G 1/8"	14,5	4	2	8	14	252M-M5-1/8
G 1/8"	G 1/8"	17	6	6	8	14	252M-1/8-1/8
G 1/8"	G 1/4"	20,5	6	6	10,5	17	252M-1/8-1/4
G 1/8"	G 3/8"	21,5	6	6	11,5	22	252M-1/8-3/8
G 1/8"	G 1/2"	24	6	6	15	24	252M-1/8-1/2
G 1/4"	G 1/4"	22,5	8	8	10,5	17	252M-1/4-1/4
G 1/4"	G 3/8"	23,5	8	8	11,5	22	252M-1/4-3/8
G 1/4"	G 1/2"	26,5	8	8	15	26	252M-1/4-1/2
G 3/8"	G 3/8"	24,5	9	12	11,5	22	252M-3/8-3/8
G 3/8"	G 1/2"	27,5	9	12	15	26	252M-3/8-1/2
G 1/2"	G 1/2"	28,5	10	14	15	26	252M-1/2-1/2

Dimensions might vary.

Accessories

4.3.4

page 29

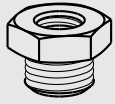
**Reducer male-female**

Cylindrical

Material: brass, nickel plated

Temperature range: -40°C ...+120°C

Maximum pressure: 50 bar

Conical versions on request.

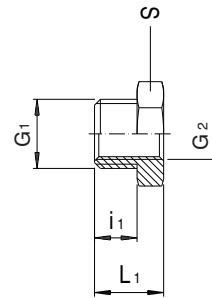

Port size G1	Port size G2	L1	i1	S	Type
G 1/8"	M 5	10,5	6	14	253M-1/8-M5
G 1/4"	G 1/8"	13	8	17	253M-1/4-1/8
G 3/8"	G 1/8"	14	9	19	253M-3/8-1/8
G 1/2"	G 1/8"	15,5	10	24	253M-1/2-1/8
G 3/8"	G 1/4"	14	9	19	253M-3/8-1/4
G 1/2"	G 1/4"	15,5	10	24	253M-1/2-1/4
G 1/2"	G 3/8"	15,5	10	24	253M-1/2-3/8
G 3/4"	G 1/2"	17,5	12	30	253M-3/4-1/2

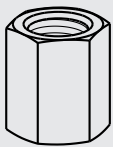
Dimensions might vary.**Socket, female**

Cylindrical

Material: brass, nickel plated

Temperature range: -40°C ...+120°C

Maximum pressure: 50 bar

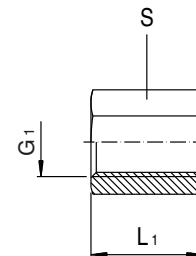

Port size G1	L1	S	Type
M 5	11	8	254M-M5
G 1/8"	15	14	254M-1/8
G 1/4"	22	17	254M-1/4
G 3/8"	24	22	254M-3/8
G 1/2"	30	26	254M-1/2
G 3/4"	32	32	254M-3/4

Dimensions might vary.

Accessories

4.3.5

page 30

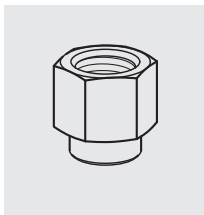
**Reducer female-female**

Cylindrical

Material: brass, nickel plated

Temperature range: -40°C ... +120°C

Maximum pressure: 50 bar

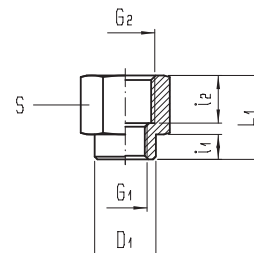

Port size G1	Port size G2	i1	i2	L1	D1	S	Type
M 5	G 1/8"	5	8	13	8	14	255M-M5-1/8
G 1/8"	G 1/4"	8	10,5	19	13,5	17	255M-1/8-1/4
G 1/8"	G 3/8"	8	11,5	20	13,5	22	255M-1/8-3/8
G 1/8"	G 1/2"	8	15	24	13,5	24	255M-1/8-1/2
G 1/4"	G 3/8"	10,5	11,5	23	17	22	255M-1/4-3/8
G 1/4"	G 1/2"	10,5	15	25	17	24	255M-1/4-1/2
G 3/8"	G 1/2"	11,5	15	27,5	21	24	255M-3/8-1/2
G 1/2"	G 3/4"	12,5	16,5	30	26	30	255M-1/2-3/4

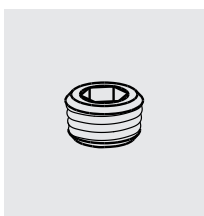
Dimensions might vary.**Plug**

Conical

Material: brass

Temperature range: -40°C ... +120°C

Maximum pressure: 50 bar

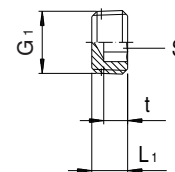

Csatlakozás G1	L1	t	S	Típusszám
1/8" K	7.5	5	5	257U-1/8K
1/4" K	10	7	6	257U-1/4K
3/8" K	11	7	8	257U-3/8K
1/2" K	13	8	10	257U-1/2K

Accessories

4.3.6

page 31

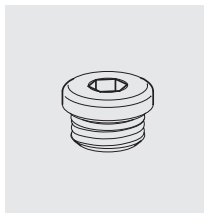

Male plug with O-ring seal

Cylindrical

Material: brass, nickel plated

Seal: NBR

Temperature range: -20°C ...+80°C

Maximum pressure: 50 bar

Long version (DIN 908) without seal in brass or steel on request.

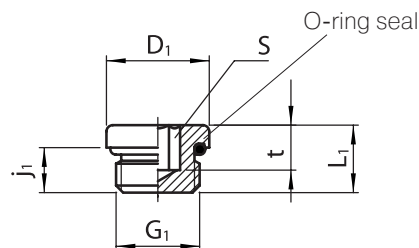

Port size G1	i1	L1	D1	S	Type
M 5	4	6	8	2	262M-M5
G 1/8"	6	8,5	14	5	262M-1/8
G 1/4"	8	11	17	6	262M-1/4
G 3/8"	9	12,5	20	8	262M-3/8
G 1/2"	10	13,5	25	10	262M-1/2

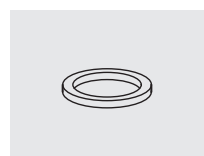

Sealing ring

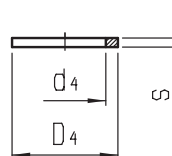

Port size	Material	Max. Temperature	D4	d4	s	Type
M 5	PVC	70°C	8	5,1	1	269N-M5x1,0
G 1/8" + M 10	PVC	70°C	14	10	1,5	269N-1/8x1,5
G 1/4"	PVC	70°C	17,5	13,5	1,5	269N-1/4x1,5
G 3/8"	PVC	70°C	21	16,7	1,5	269N-3/8x1,5
G 1/2"	PVC	70°C	26	21,3	1,5	269N-1/2x1,5
G 1/8" + M 10	Fiber	90°C	14	10	1,5	264V-1/8x1,5
G 1/4"	Fiber	90°C	17,5	13,5	1,5	264V-1/4x1,5
G 3/8"	Fiber	90°C	21	16,7	1,5	264V-3/8x1,5
G 1/2"	Fiber	90°C	25	21,3	1,5	264V-1/2x1,5
M 5	Alu	120°C	7,5	5,1	0,5	265A-M5x0,5
M 5	Alu	120°C	7,5	5,1	1	265A-M5x1,0
M 5	Alu	120°C	8	5,1	1,5	265A-M5x1,5
G 1/8" + M 10	Alu	120°C	14	10,3	1,5	265A-1/8x1,5
G 1/4"	Alu	120°C	17,5	13,5	1,5	265A-1/4x1,5
G 3/8"	Alu	120°C	21	16,7	1,5	265A-3/8x1,5
G 1/2"	Alu	120°C	25	21,3	1,5	265A-1/2x1,5
G 3/4"	Alu	120°C	32	27,2	1,5	265A-3/4x1,5

